

HBS20 has a multifunction of the trapping, stopping and bypassing

## Features

- Bypass piping is not necessary.  
It contributes to reduce the piping work and to simplify the piping design.
- The change of trapping, bypassing and stopping can be done easily by a monkey wrench.
- Stable operation at any installed position.
- Easy to maintain the trap because the cover can be disassembled without taking off the trap from piping.

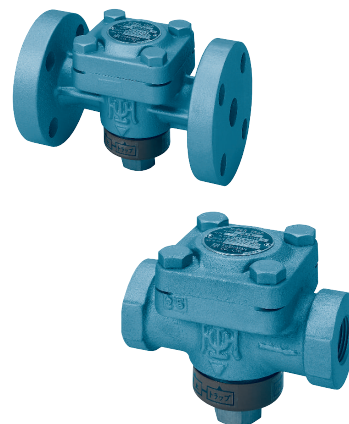

## Specifications

Fluid		Steam, condensate		
Maximum pressure		1.6MPa	1.0MPa	1.6MPa
Maximum temperature		200°C		
Maximum differential pressure		1.6MPa	1.0MPa	1.6MPa
Size		15—25	15—25	20, 25
Connection		Screwed JIS Rc	Flanged JIS10KFF	Flanged JIS16KFF
Material	Body, Cover	Cast iron		Spheroidal graphite cast iron
	Seat	Stainless steel		
	Capsule	Hastelloy & stainless steel (N membrane or U membrane)		
	Gasket	Teflon		
Weight		15, 20A : 2.4kg, 25A : 2.3kg	15 : 3.8kg, 20A : 4.0kg, 25A : 5.0kg	20A : 3.6kg, 25A : 5.1kg
Use for		Radiator, Small storage tank, Unit heater, Automatic air vent valve		

## Changing

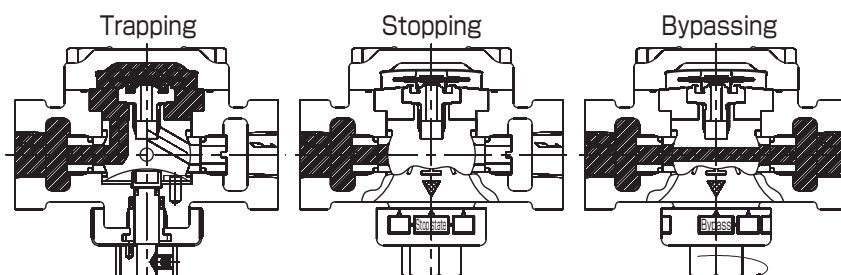

## Construction

Screwed

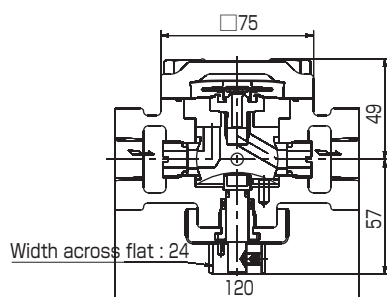

Flanged

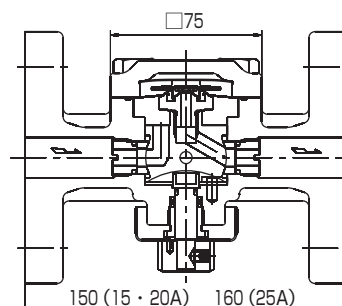

# Type HBS20 Steam Traps

## Capacity

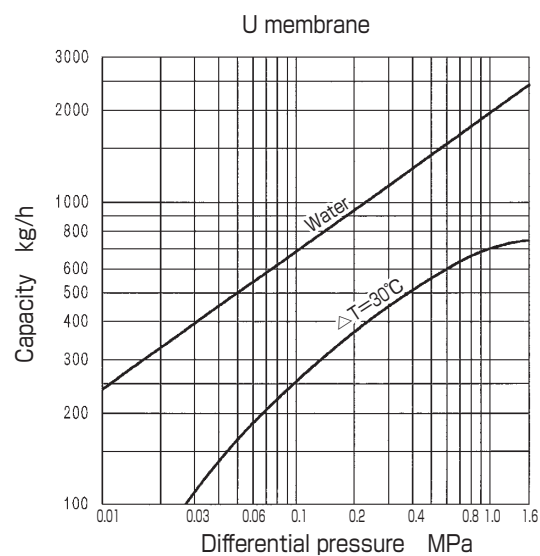
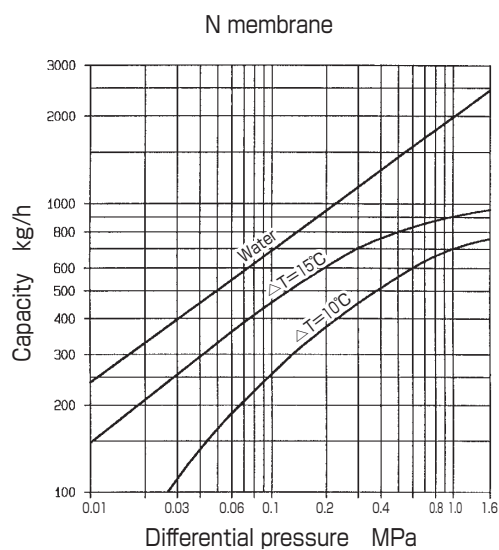

$\Delta T$  = saturated temp. – condensate temp.