

**Automatic Air
Vent Valve
Made of bronze**

Type A113-1MCA Automatic Air Vent Valves

Small sized but large capacity automatic air vent valve.

Features

- Since valve disc is not linked with float at closed position, there is no water leakage due to vibration of piping or pulsation of water.
- All materials are non-corrosive, so water will not be contaminated.
- Small-sized but large capacity on account of own construction.
- Since the air is breathed soon at negative pressure, piping and equipment are not damaged.
- Float, made of synthetic resin, is prevented from water absorption and mechanical damages.



Specifications

Material	Fluid	Cold and hot water
	Size	15-25
	Max. allowable pressure	1.0MPa
	Max. allowable temperature	90°C
	Body	Brass (Nickel plated)
	Disc	Synthetic rubber
	Seat	Phosphorous bronze
	Float	Synthetic resin
	Connection	Screwed JIS Rc

Construction

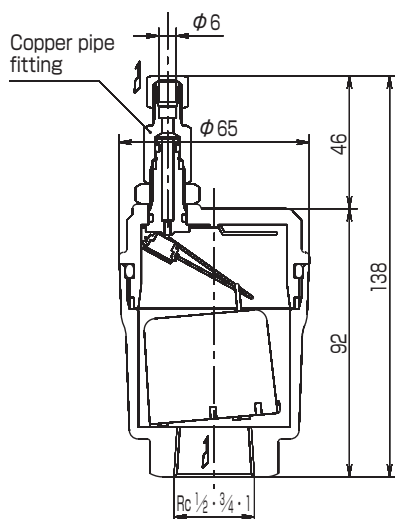

Example

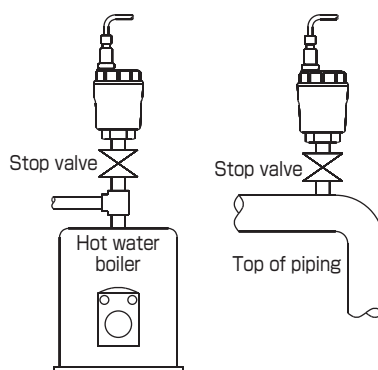

Air vent capacity

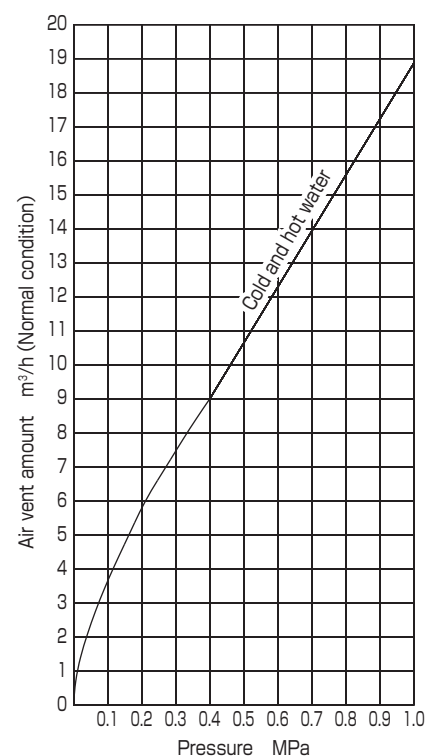

Notice for installation

- Install on the top of piping or equipment, as vertically as possible.
- Install stop valve at the inlet to shut off water during maintenance and inspection.
- At first flow, blow off the piping and equipment sufficiently after closing above mentioned stop valve to prevent coming foreign matters into air vent valve.
- In the event that foreign matters attach on the disc, water leakage may occur. Copper piping with 6mm outside diameter shall be provided on the outlet of valve and lead to drainage ditch.
- Please refer to instruction manual for detail.